

1:1

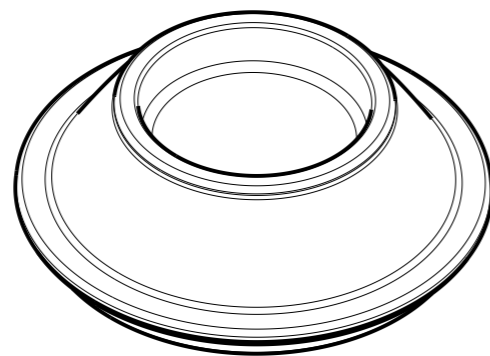

1:1

- Quality checked
- Constructional dimension
- Dimension for information only

| | | | | |
|--|--|-----------------|---------|--|
| Scale | | Material | | Tolerances unless otherwise specified are $\pm 1\%$, but minimum ± 0.5 mm |
| 2:1 (1:1) (5:1) | | SUPRAX® 8488 | | |
| | | 78g | | |
| Date | | Name | | Lens PAR 38 |
| 10-Sep-14 | | Günter | | |
| Checked 09-Nov-15 | | | | |
| Final part number (SAP) | | | | 150 0655 |
| Drawing number | | | Version | Project |
| 71471_000_001_a13 | | | 01 | 71471 |
| Auer Lighting GmbH Hildesheimersstrasse 35 D-37581 Bad Gandersheim Tel: +049 (0)5382 / 701-0 www.auer-lighting.com | | | | |
| | | | | A3 |

| | | |
|--------------|-----------|--------|
| New revision | 09-Nov-15 | Günter |
| Änderung | Datum | Name |

This drawing is our property. Multigraphing and sending copies to third parties is punishable, bound to claim for damages and prosecution. (Copyright law, law against unfair competition, BGB). All rights reserved for patent application (§7 PG) or registered design (§5 GMG).