

LIGHT GUIDE ROME 3,2 – 45 MM



Material number: 1501763

Glass: SUPRAX® 8488
Borosilicate Glass

Length: 45 mm
Input aperture: 3,2 x 3,2 mm
Output aperture: 5,4 x 5,4 mm

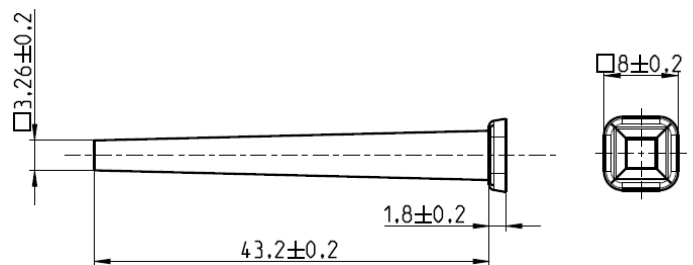

Packing unit: 1 pc

Properties:

Polished input/output aperture
Flange for easy mounting
Transmittance: up to 94%
Permanent operating temperature: 400°C
Efficiency option: AR coatings

Optics:

LEDs: e. g. OSRAM OSTAR S2WN,
S2W, LED Engin LZ4

Customs tariff number: 70140000