

## LIGHT GUIDE ROME 3,9 – 70 MM



**Material number:** 1500723

**Glass:** SUPRAX® 8488  
Borosilicate Glass

**Length:** 70 mm  
**Input aperture:** 3,9 x 3,9 mm  
**Output aperture:** 5,8 x 5,8 mm

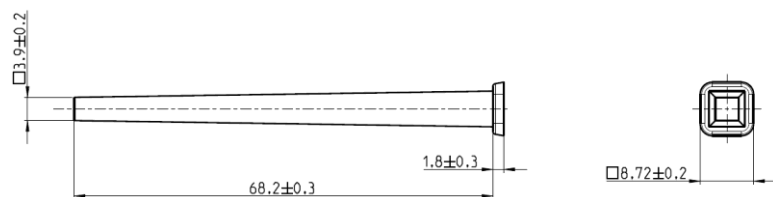

**Packing unit:** 1 pc

**Properties:**

Polished input/output aperture  
Flange for easy mounting  
Transmittance: up to 94%  
Permanent operating temperature: 400°C  
Efficiency option: AR coatings

**Optics:**

**LEDs:** e. g. OSRAM OSTAR S2WN, S2W, S2WP;  
LED Engin LZ4, LZ7

**Customs tariff number:** 70140000