

LIGHT GUIDE ROME 3 – 70 MM

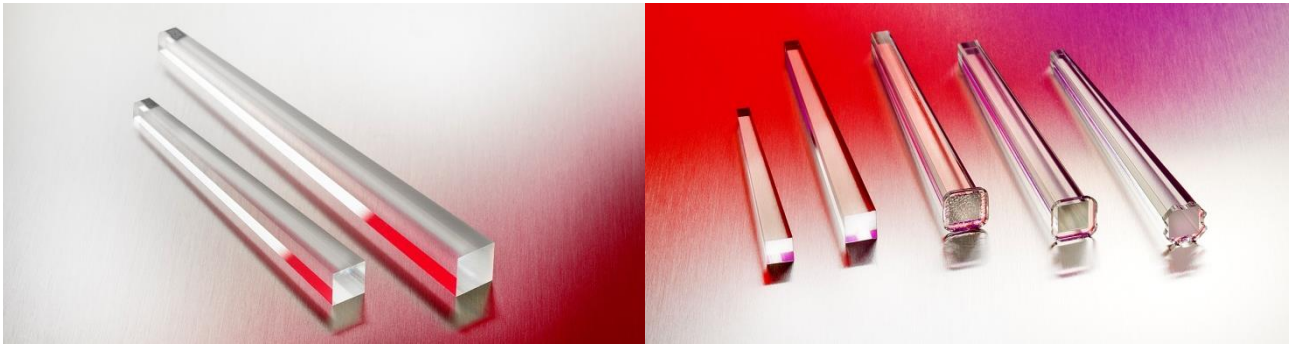

Material number: 1500702

Glass: SUPRAX® 8488
Borosilicate Glass

Length: 70 mm
Input aperture: 3 x 3 mm
Output aperture: 6 x 6 mm

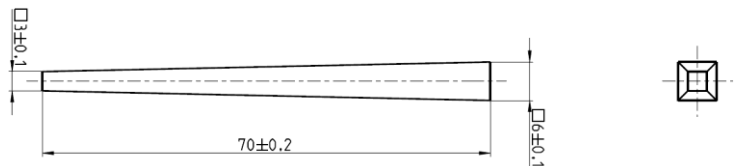

Packing unit: 1 pc

Properties:

Polished input/output aperture
Transmittance: 94 %
Permanent operating temperature: 400°C
Coating: AR (optional)

Optics:

LEDs: e. g. OSRAM OSTAR S2WN,
S2W, LED Engin LZ4

Customs tariff number: 70140000